



BHANSALI METALLOYS INC

An ISO 9001:2015 | ISO 14001:2015 | ISO 45001:2018
| EUROPEAN DIRECTIVE 2014/68/EU

ABOUT COMPANY

Bhansali Metalloys Inc is a force to reckon with in the field of Manufacturing, Export & Supply premium quality Fittings, & Fasteners in Carbon Steel, Alloys Steel, Stainless Steel, Copper Alloys, Aluminium Alloys and High Temperature, Low Temperature Products.

Company Contact Details: -

Mr. Dhruvil Bhansali

Contact No.: -

+91-9152160158

+2266394787

Email ID:-

infobmi32@gmail.com

exportbmi32@gmail.com

Visit Us:-

<https://bhansalimetalloysinc.com/>

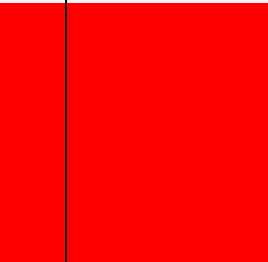

Bhansali Metalloys Inc

<https://bhansalimetalloysinc.com/> | <https://fastenersexportersinindia.com/>
EMAIL ID:- infobmi32@gmail.com | CONTACT NO:- +91-9152160158



Quality Policy

We always strive for excellence and in that process, we never forget to lag behind in quality of the product which we make with higher efficiency, we always pursue to make better innovative products and most importantly to gain customer's satisfaction. The Company always looks forward to serve the purpose of the client.

Our Facilities

- Bar Drawing Section
- Press Shop
- Forging Shop
- Turning Section
- Packing Section
- Bolt Forming Section
- Nut Forming Section
- Nut Cutting Section

Our Mission

Every company needs a mission to accomplish certain goals that they have set and we as a company have our set of missions that we always give prior importance to. To Provide the most excellent quality Products & Services by Maintaining High Standard of Manufacturing, at low cost, on time delivery with Customized Products with Total Clients Satisfaction.

Our Vision

We assist customers develop their energy resources bringing world class potential and delivering it locally. We promote commercial provision that is aligned to our customers' needs, allowing us to transport more value to the customer while growing the returns from our most precious asset our people.



Our Products

HEX BOLTS / HEX SCREWS / HSEFG BOLTS

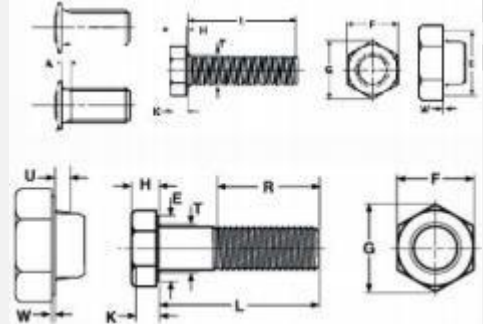

HEX BOLTS /SCREWS: A HEX Bolt threaded with metric & inch thread pitch. Generally manufactured in accordance with DIN Standard 933/931, ISO Standard 4017/4014, ASME B 18.2.1, IS 1364 Size.

Size		Length		Property Class		Equivalent Standards
Metric	Inches	Metric	Inches	High tensile	Stainless Steel	IS 1364,ISO 4014/4017,DIN931, DIN 933,BS 1083 BSF/BSW, 1768 UNC/UNF , ANSI/ASME B18.2.1
M16-M80	5/8"- 3"	Up To 600 MM	Up To 24"	4.6,5.6,6.4, 8.8,10.9,12.9, 14.9,B7	SS304,316, B8,B8M,201, 317,310,410, Duplex steel 2205	

SQUARE BOLTS

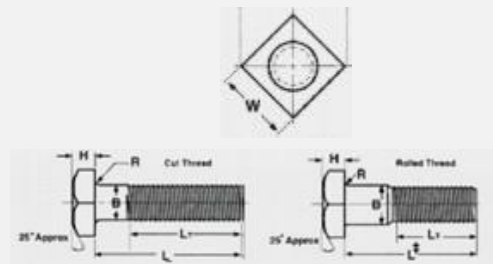

Square Bolts :- An externally threaded fastener, with a trimmed, square shaped external wrenching head Used in applications where the use of power tools is impractical or undesirable offers greater bearing area for more positive gripping with a hand wrench.

Size		Length		Property Class		Equivalent Standards
Metric	Inches	Metric	Inches	High tensile	Stainless Steel	DIN 480 & AS PER CUSTOMER SPECIFICATION
M16-48	5/8"- 2"	Up To 600 MM	Up To 24"	4.6,5.6,6.4, 8.8,10.9,12.9, 14.9,B7	SS304,316, B8,B8M	



Our Products

SOCKET HEAD

Socket Head :- An externally threaded fastener with metric threads, a cylindrical head with a flat chamfered top surface, knurled cylindrical sides, and a hexagonal recess. Generally manufactured in accordance with DIN Standard 912 or ISO Standard 4762, ASTM B 18.2.3.1M

SIZE RANGE : M16 - M 42 LENGTH : 350 mm GRADE : 8.8, 12.9, 14.9, ss 304, ss 316

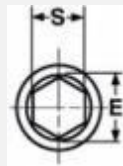
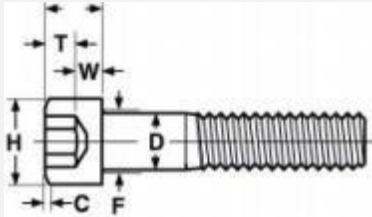

COUNTERSUNK

Countersunk :- Has a similar design as a metric button head socket cap screw, but has a 90° countersunk flat head. Generally manufactured in accordance with DIN Standard 7991.

SIZE RANGE : M 16 M 24 LENGTH: 200mm GRADE : 8.8, 12.9, 14.9, SS 304, SS 316

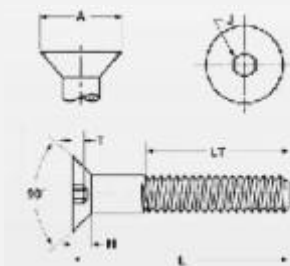

SOCKET SET SCREW

Socket Set Screw :- A headless screw threaded the entire length, with a hexagonal drive at one end and a point at the other end (e.g., cup, half dog, oval, flat, and cone). Used for internal wrenching and where frequent disassembly or adjustment occurs.

SIZE RANGE : M 16 M 24 LENGTH: 200 MM GRADE : 8.8, 12.9, 14.9, SS 304, SS 316

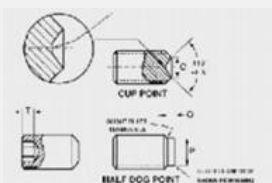



Our Products

T HEAD BOLT (DIN 186 FORM A)

T Head Bolt :- SIZE RANGE : M 16-M 42 LENGTH : 300 mm GRADE : 4.6, 8.8, 12.9, 14.9, ss 304, ss 316



CARRIAGE BOLTS

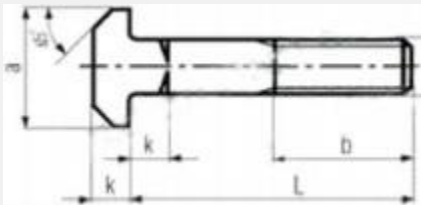

Carriage Bolts :- A round head bolt with a square neck under the head and a unified thread pitch. Designed to keep the bolt from turning when a nut is being tightened. The short neck variety is used in sheet metal where a standard sized neck would create an obstruction.
SIZE RANGE : M 16-M 24 LENGTH : 300 mm GRADE : 8.8, 12.9, 14.9, ss 304, ss 316

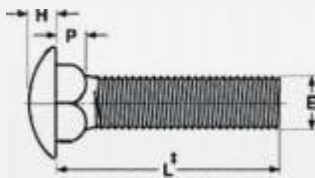

HEXAGONAL FIT BOLTS

Hexagonal Fit Bolts :- A headless screw threaded the entire length, with a hexagonal drive at one end and a point at the other end (e.g., cup, half dog, oval, flat, and cone). Used for internal wrenching and where frequent disassembly or adjustment occurs.

SIZE RANGE : M 12 - M 48 LENGTH : 600 mm GRADE : 8.8, 12.9, 14.9, ss 304, ss 316

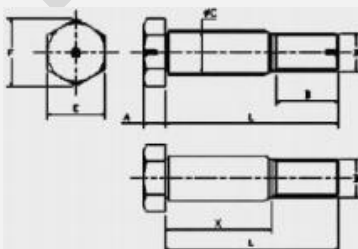



Our Products

COUPLING NUTS

Coupling Nuts :- A six-sided, double chamfered nut that is available in various widths and lengths. **Hex Couplers** are used to connect two pieces of threaded material. Hex and heavy hex couplers are threaded right hand. If a right hand-left hand coupler is needed, consider using a sleeve nut.

SIZE RANGE : M 16-M 30 GRADE : CLASS 4, 8, 10, 12, SS 304, SS 316

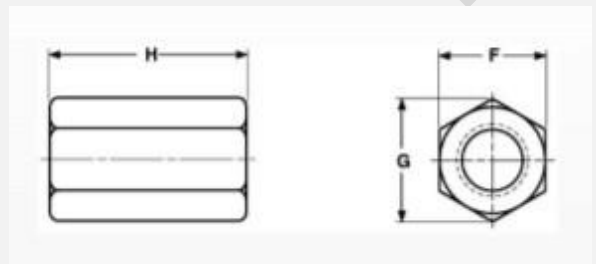

HEAVY HEX NUTS

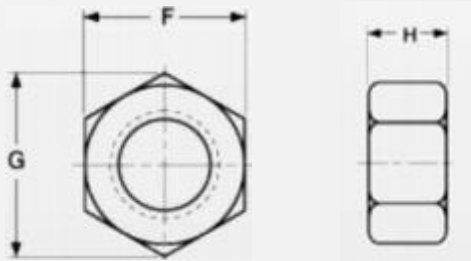

Heavy Hex Nuts :- A six-sided internally threaded fastener with metric thread / inch Thread pitch. 16-millimeter nuts and smaller are chamfered on the top and the bearing surface. Larger nuts may be double chamfered, or have a washer face on one side and a chamfered surface on the opposite side. A **Heavy Hex Nut** made of alloy steel, manufactured in accordance with ASTM Standard A194 Grade 2H. Used for high-temperature and high-pressure conditions.

Size		Property Class		Equivalent Standard
Metric	Inches	High tensile	Stainless Steel	IS 1364, ISO 4032 DIN934, UNC/UNF , ANSI/ASME B18.2.2, B 18.2.4.6M
M16-M64	5/8" - 2 1/2"	Class 4, 8, 10,12, 2H	SS304,316, B8,B8M, 410,Duplex steel 2205	



Our Products

SQUARE NUTS (DIN 557)

Square Nuts :- A four-sided, internally threaded fastener with a flat bottom side and a chamfered, washer-crowned top. **Square Nuts** are usually provided with a square bolt and used heavily in the utility and pole line industry. Designed for use with square bolts. **SIZE RANGE : M 16-M 48**

GRADE : CLASS 4, 8, 10, 12, SS 304, SS 316

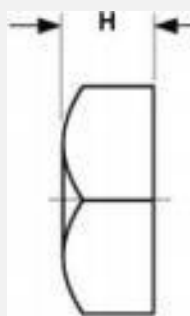
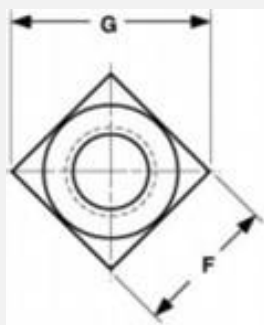

HEX JAM NUTS

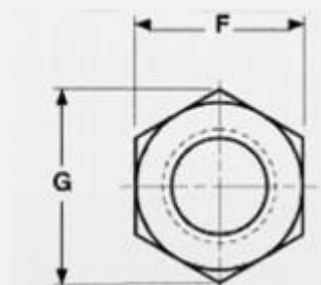

Hex Jam Nuts :- A six-sided internally threaded fastener which is thinner than the thickness of a finished hex nut. Used in combination with a finished hex nut to keep the nut from loosening Hex jam nuts are thinner than a standard hex nut but have the same dimension across the flats and corners. **Hex jam nuts** have two common applications. A jam nut can be threaded onto a bolt and run tight against the standard nut which will lock the nut in place and prevent it from backing off. Jam nuts are sometimes used for levelling purposes as well.

Size		Property Class		Equivalent Standard
Metric	Inches	High tensile	Stainless Steel	IS 1364, ISO 4032 DIN439, UNC/UNF , ANSI/ASME B18.2.2, B 18.2.4.6M
M16-M64	5/8"- 2.1/2"	Class 4, 8 , 10,12, 2H	SS304,316, B8,B8M, 410,Duplex steel 2205	



Our Products

U BOLTS (SQUARE / ROUND)

U Bolts :- Square bent U-Bolts are typically used for attaching product to a square shaped post. They can also be embedded in concrete and used as anchor bolts. Round bend **U-Bolts** are typically used for attaching pipe or steel round bar to a round wood or steel post. Another common application is to hang wrought iron pipe in mechanical installations. They can also be embedded in concrete as anchor bolts.

Bhansali Metalloys inc manufactures custom round bend U-bolts from 1/2" through 3" in diameter to virtually any ASTM specification & DIN 3570. They are provided either plain finish or hot-dip galvanized. Other metals like 304 and 316 stainless steel U-Bolts are also manufactured. All operations, including the galvanizing process, are performed in-house.

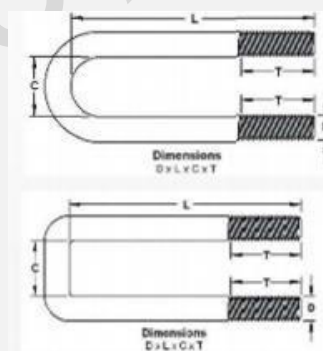

THREADED BAR / TIE ROD

Threaded Bar / Tie Rod :- Alloy Steel / Stainless Steel / Carbon Steel:

A **Pre-Threaded Bar** with metric/ inch thread pitch which may be cut to length with a metal cutting hacksaw or power band saw. A nut will move easily over clean cut ends. Only minimal burr removal may be required from rough cut ends.

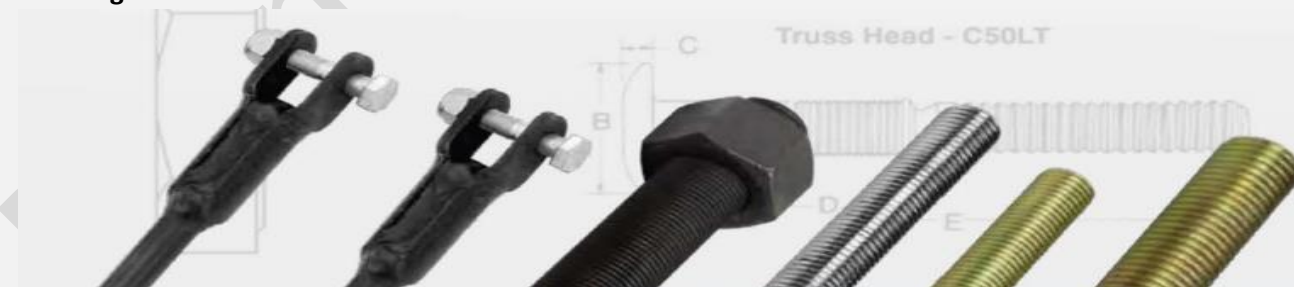

Size		Property Class			Equivalent Standard	
Metric	Inches	Metric	Inches	High tensile	Stainless Steel	DIN 975 DIN 976 DIN 939 IS 1862 TYPE 1,2,3
M10-M80	3/8"- 3"	Up To 600 MM	Up To 236"	4.6,5.6,6.4, 8.8,10.9,12.9, 14.9,B7	SS304,316, B8,B8M, 410 201	



Our Products

ANCHOR BOLTS (RIGHT ANGLE BEND) / FOUNDATION BOLT

Anchor Bolts :- Bent Anchor Bolts are embedded in concrete and used to support structural steel columns, light poles, highway sign structures, bridge rail, equipment, and many other applications. The bent portion, or "leg", of the anchor bolt serves to create resistance so that the bolt does not pull out of the concrete foundation when force is applied. [Bhansali Metalloys Inc](#) also manufactures other concrete anchor bolt configurations including anchor rods, headed anchor bolts, and swaged rods manufactures custom bent anchor bolts from 1/2" - 4" diameter as per customer requirement & drawing. They are provided either plain finish or hot-dip galvanized. [Stainless Steel Anchor Bolts](#) are also manufactured. All operations, including the galvanizing process, are performed in-house.

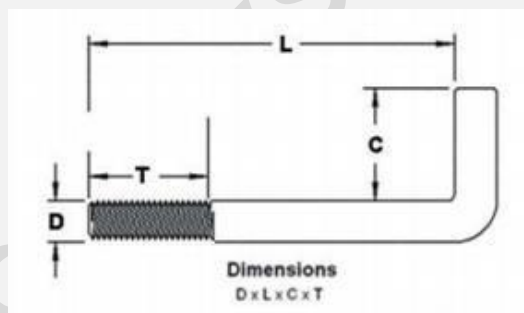

DIN 529 - ANCHOR BOLTS (STONE BOLT)

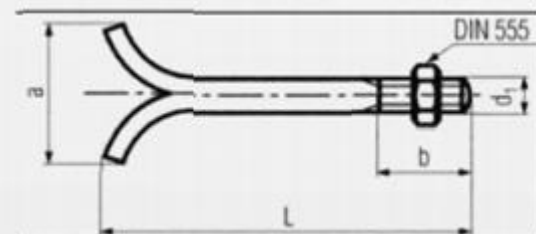

[Bhansali Metalloys Inc](#) manufactures custom closed & open eye bolts from 11.2" - 111.2" diameter as per standard. Also referred to as "turned" eye bolts, they are often welded closed. [Eye bolts](#) are provided either plain finish or hot-dip galvanized. Stainless steel eye bolts are also manufactured. All operations, including the galvanizing process and welding, are performed in-house.

EYE BOLTS (CLOSED / OPEN)

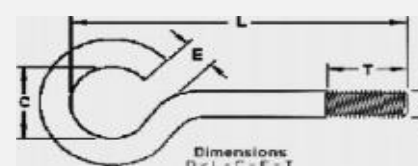
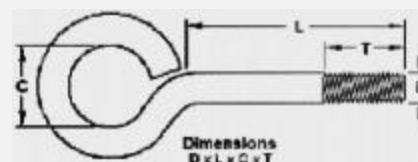



Our Products

AIR RELEASE PLUG / HEX PLUG

MATERIAL: SS 304 / SS 316 / MILD



WASHERS (PUNCHED & MACHINED)

Washers provide a smooth bearing surface and are used under the head of a bolt and / or a nut. The chemical, mechanical, and dimensional requirements for hardened **washers** are covered under the ASTM specification, washers are through hardened or carburized to add strength.

SUB GROUP: standard flat / Hardened washers / Square washers / Spring Washers

Material: STAINLESS STEEL I MILD STEEL DIMENSION: AS PER DIN 125 A / B

SIZE RANGE: M 8- M 42



THEROMETER POCKET

MATERIAL: BRASS, SS 304, SS 316





Our Products

COUPLING BOLT

MATERIAL: SS 304, SS 316 / MILD STEEL



ANCHOR BOLT ASSEMBLY

MATERIAL: SS 304 / SS 316

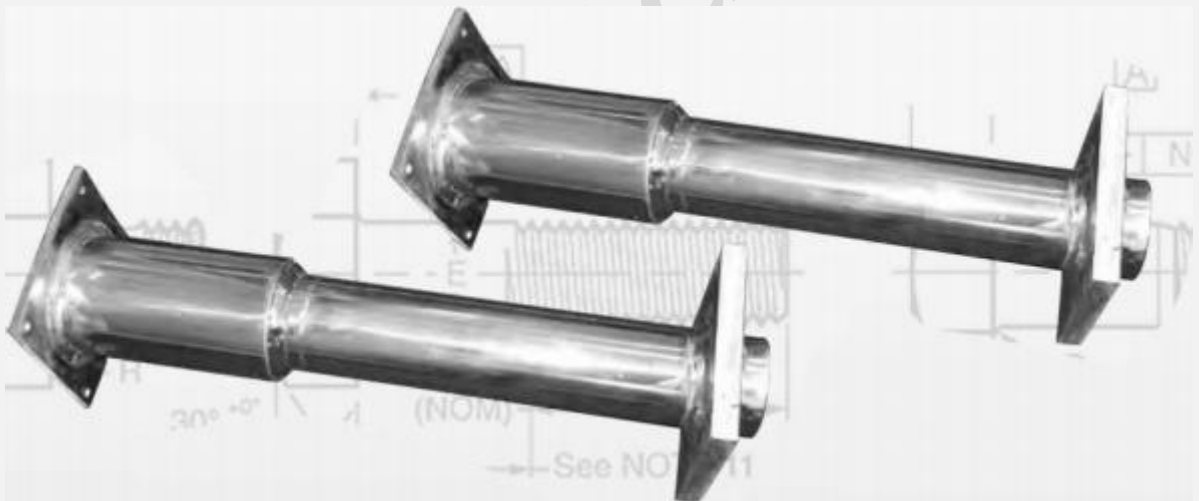

ANCHOR BOLT ASSEMBLY

MATERIAL: SS 304 / SS 316



TECHNICAL SPECIFICATIONS



FASTENERS PRODUCT RANGE AND QUICK SELECTION GUIDE:

PRODUCT	SIZE RANGE				PROPERTY CLASS		EQUIVALENT STANDARDS				
	DIAMETER		LENGTH								
	METRIC	INCH	METRIC	INCH	METRIC	INCH	IS	ISO	DIN	BS	ANSI/ASME
High Tensile Hex Head Screws/Bolts	M16 to M64	5/8" to 2.1/2"	25 mm to 750 mm	1" to 30"	8.8, 10.9. Also in 9.8 & 12.9, 14.9, B7, B16 etc	Grade R,S,V,X and Gr 5 , Gr 8	1364	4014 4017	931 933	BS 1768	B18.2.1/B18.2.1M ASTM 193 / 307
High Tensile Hex Nuts	M16 to M64	5/8" to 2.1/2"			Gr 8, Gr 10, Gr 12, Gr 2H, Gr4 etc	Gr 8, Gr R, Gr 5	1364	4032	934	BS 1768	B18.2.4.1M/ B18.2 ASTM 194
Stainless Steel SS-304 Hex Head Screws/Bolts	M16 to M64	5/8" to 2.1/2"	25 mm to 750 mm	1" to 30"	A2 - 50, 70, 80, B8	Equivalent to A2 - 50, 70, 80	1364	4014 4017	931 933	BS 1768	B18.2.1 / B18.2.1M ASTM 193 / 307
Stainless Steel SS-316 Hex Head Screws/Bolts	M16 to M64	5/8" to 2.1/2"	25 mm to 750 mm	1" to 30"	A4 - 50, 70, 80, B8M C1 / C2	Equivalent to A4 - 50, 70, 80	1364	4014 4017	931 933	BS 1768	B18.2.1 / B18.2.1M ASTM 193 / 307
Stainless Steel Hex Nuts in SS-304 and SS-316	M16 to M64	5/8" to 2.1/2"			A4-50, 70, 80, B8 A4-60, 70, 80, B8M	Equivalent Property Class	1364	4032	934	BS 1768	B18.2.4.1M/ B18.2.2 ASTM 194
High Tensile and Stainless Steel Socket Head Cap Screws	M16 to M36	5/8" to 1-1/2"	25 mm to 600 mm	1" to 24"	8.8, 10.9, 12.9, A2-50, 70, 80, A4-50, 70, 80	Equivalent Property Class	2269	4762	912	BS 4168 (Metric) , BS 2470 (Inch)	B18.3.1M / B18.3
High Tensile and Stainless Steel Fully Threaded Studs	M16 to M64	5/8" to 3"	1 Meter, 2 Meter, 3 Meter	3 Feet, 6 Feet, 9 Feet	8.8, 10.9, A2 - 70, A4 - 70	Equivalent Property Class			975 / 976		B16.5.1
High Tensile and Stainless Steel Double Ended Studs	M16 to M64	5/8" to 2.1/2"	25 mm to 750 mm	1" to 30"	8.8, 10.9, A2 - 70, A4 - 70	Equivalent Property Class	1862		939 / 936 940		
High Strength Structural Bolts, Nuts and Washers	M16 to M36	1/2" to 1.1/2"	40 mm to 300 mm	1.1/2" to 12"	8.8 S, 10.9 S Or Equivalent	Equivalent Property Class	3757, 6623, 6649	7412, 4775, 7415	6913, 6914, 6915	BS 4395	ASTM 325, A563, F436 / ASTM A 450, ASTM 307
Stud Bolts with 2 Heavy Hex Nuts	M16 to M64	5/8" to 3"	25 mm to 3000 mm	1" to 120"	As per Std eg. B7/B8/B8M C1/C2 /B16 etc						A193 / A 320 / A 194 / A 307
Special Products	As per Customer Drawings/Samples and Specifications										

Above details are indicative and are subject to change without any notice

TECHNICAL SPECIFICATIONS

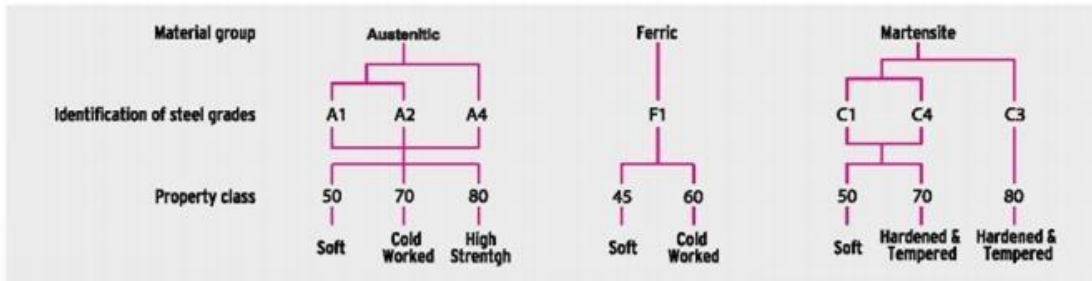

Stainless steel Markings only

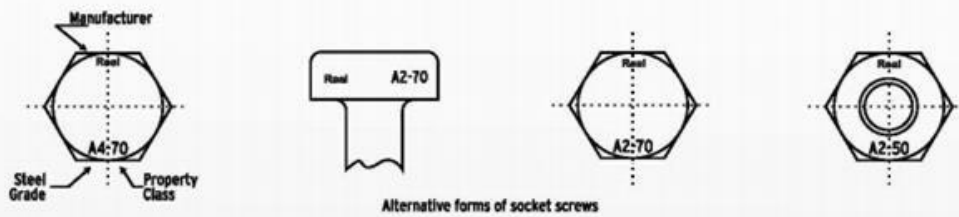

Bolts, Screws and Studs

Grade	Property Class	Tensile Strength Rm. M.Pa (N/mm ²) min	Yield Stress Pp 0.2 M.Pa (N/mm ²) min	Elongation A1 min
A2 and A4	50	500	210	0.6d
A2 and A4	70	700	450	0.4d
A2 and A4	80	800	600	0.3d

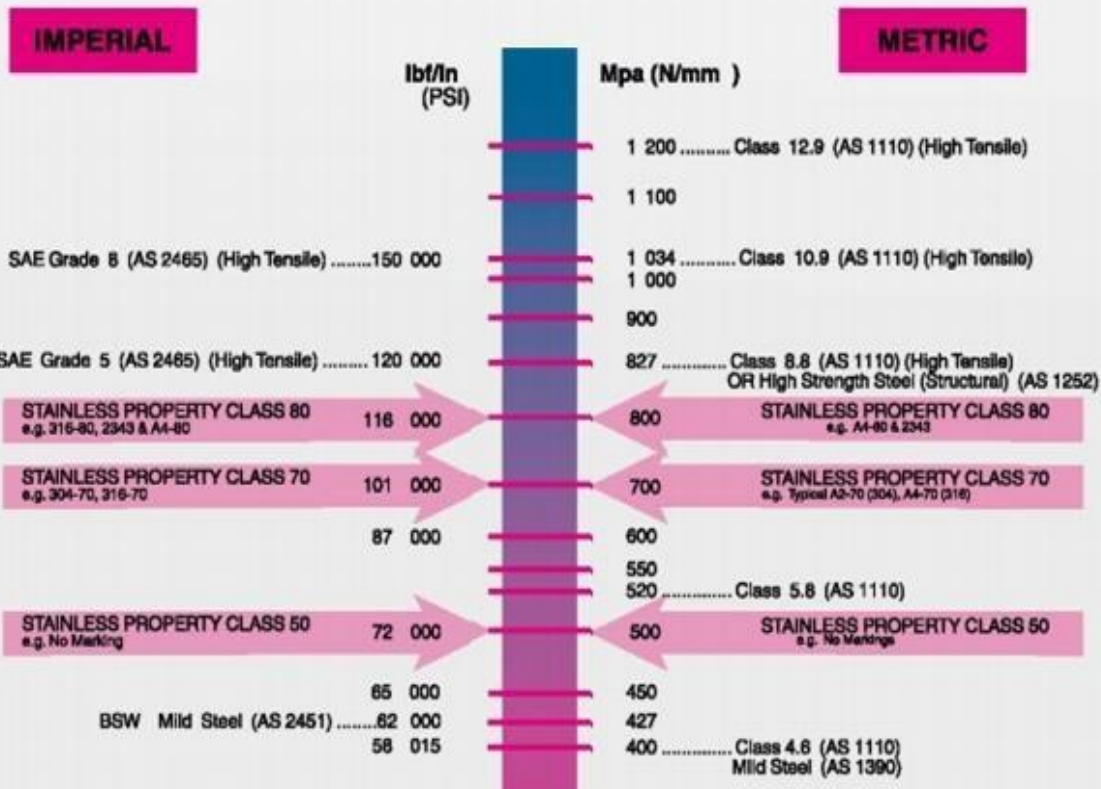



APPLICATION

❖ Fertilizers Plants.	❖ Pre Engineer Buildings and Other Application.
❖ Indian Railways.	❖ Locomotive Manufacturers.
❖ Civil Construction Industries.	❖ Heavy Engineering Industries.
❖ Defence Organizations.	❖ Earth Moving Equipment Manufacturer.
❖ Steel Plants.	❖ Petro-Chemical Industries.
❖ Elevators Manufacturers.	❖ Power Generation Units, Nuclear, Hydro or Thermal.
❖ Ship Building Industries.	❖ Oil Exploration Project.



Oil & Gas Industries



Aerospace Industries



Fertilizers Industries



Automobile Industries



Chemical Industries



Paper & Pulp Industries



Get in Touch

Address: 2nd Panjrapole Lane, Shreenath 27 CHS Building, 1st Floor Office No.16, Gulal Wadi, Mumbai – 400004.

CONTACT INFO:

Mr. Dhruvil Bhansali

+91-9152160158 | +2266394787

Email ID: infobmi32@gmail.com

EXPORT/INTERNATIONAL CONTACT INFO:

Mr. Kunal Bhansali

+91-7738722137

Email ID: exportbmi32@gmail.com

VISIT US:

<https://bhansalimetalloysinc.com/>

<https://fastenersexportersinindia.com/>

